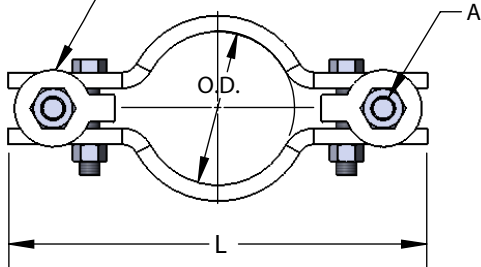
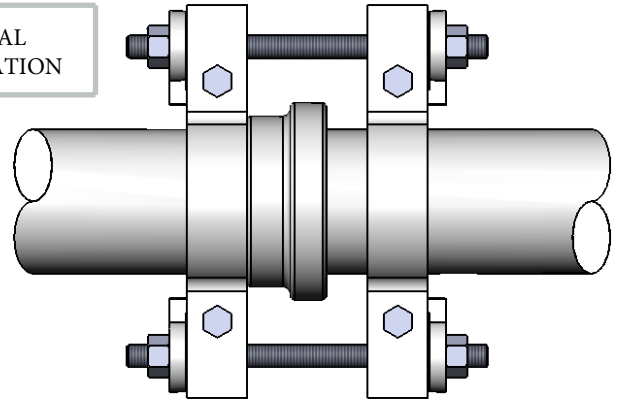

FIG. 599 WASHER
ORDER SEPARATELY



TYPICAL
INSTALLATION



| | | |
|---------------------|---|----------------------------------|
| Materials/Finishes: | Plain Carbon Steel (600DIPB) | Electro-Galvanized (600DIPG) |
| | Hot-Dip Galvanized (600DIPHDG) | T-304 Stainless Steel (600DIPSS) |
| | T-316 Stainless Steel (600DIPSX) | |
| Variants: | N/A | |
| Service: | Designed to be used to clamp joints of underground AWWA ductile iron water lines to prevent joint separation due to excessive water pressure. | |
| Approvals: | N/A | |
| Ordering: | Specify figure number, finish and size. | |
| Notes: | N/A | |

| PIPE SIZE | PIPE OD | BOLT | A ROD DIA. | INNER DIA. | L | WGT EACH (lbs) |
|-----------|---------|-------|------------|------------|--------|----------------|
| 3 | 3.960 | 5/8 | 3/4 | 3.96 | 12 | 5.95 |
| 4 | 4.800 | 5/8 | 3/4 | 4.8 | 12-3/4 | 8.00 |
| 6 | 6.900 | 5/8 | 3/4 | 6.9 | 15-1/2 | 10.00 |
| 8 | 9.050 | 5/8 | 3/4 | 9.05 | 17-1/2 | 12.10 |
| 10 | 11.100 | 5/8 | 3/4 | 11.1 | 19-1/2 | 13.63 |
| 12 | 13.200 | 5/8 | 3/4 | 13.2 | 22 | 15.65 |
| 14 | 15.300 | 7/8 | 1 | 15.3 | 28-1/2 | 45.00 |
| 16 | 17.400 | 1 | 1-1/8 | 17.4 | 30-3/4 | 63.00 |
| 18 | 19.500 | 1-1/4 | 1-1/4 | 19.5 | 34-5/8 | 76.00 |
| 20 | 21.600 | 1-1/4 | 1-3/8 | 21.6 | 37-1/2 | 100.50 |
| 24 | 25.800 | 1-1/2 | 1-1/2 | 25.8 | 43 | 118.00 |

| PROJECT INFORMATION | APPROVAL STAMP |
|---|----------------|
| Project: | Notes: |
| Address: | |
| Contractor: | |
| Engineer: | |
| Date: | |
| Approved Approved as Noted Not Approved | |